



Uniform Policy

Elanora State High School is a uniform school in accordance with the decision made by the parent community (P&C). A school uniform helps in achieving the school's identity, cohesion, tone, pride and spirit.

ALL students are required to wear the uniform correctly and are encouraged to take pride in their appearance by keeping their uniform neat and tidy. Sleeves must not be turned up and shorts and skirts must not be turned up or down. Skirts and shorts must be worn at the length sold with school logo visible. *No modifications are permitted without the Principal's written approval.*

Junior School – Girls		Senior School - Girls	
Skirt	Navy skirt with school logo.	Skirt	Tartan skirt with school logo.
Shorts	Navy with school logo.	Shorts	Navy, with school logo.
Blouse	Pin-striped blouse with school logo.	Blouse	White blouse with school logo.
Shoes	All black leather lace-up school type or black jogger with leather upper and all-purpose sole.	Shoes	All black leather lace-up school type or black jogger with leather upper and all-purpose sole.
Socks	White socks visible to ankle bone.	Socks	White socks visible to ankle bone.
Stockings	Stockings are optional but must be either navy, black or flesh coloured without a pattern.	Stockings	Stockings are optional but must be either navy, black or flesh coloured without a pattern.
Hat	Bucket hat or cap with school logo	Hat	Bucket hat or cap with school logo
Junior School – Boys		Senior School – Boys	
Shorts	Navy with school logo.	Shorts	Navy with school logo.
Shirt	Pin-striped shirt with school logo.	Shirt	White shirt with school logo.
Shoes	All black leather lace-up school type or black jogger with leather upper and all-purpose sole.	Shoes	All black leather lace-up school type or black jogger with leather upper and all-purpose sole.
Socks	White socks visible to ankle bone.	Socks	White socks visible to ankle bone.
Hat	Bucket hat or cap with school logo	Hat	Bucket hat or cap with school logo
Sport Uniform			
Shorts	Navy shorts with school log.		
Shirt	Blue sports polo with school logo.		
Shoes	All black lace-up leather school type or black jogger, change to sport specific shoe only during HPE lesson and/or while competing.		
Socks	White socks visible to ankle bone.		
Hat	Bucket hat or cap with school logo		
Winter Uniform			
Jacket – Option 1	Fleece with school logo on front. Year 12 students may wear a senior jersey in accordance with school guidelines.		
Jacket – Option 2	Navy with school logo on front.		
Long pants	Navy tailored pant with school logo.		
Track pants – Opt1	Navy fleece with school logo on left hip.		
Long pants – Opt 2	Navy soft shell pant with school logo on left hip.		

Shoes:

- **All black leather** lace-up school type or black jogger with leather upper and all purpose sole or black leather school shoes and with no coloured markings or non-black sides in accordance with enclosed photos.
- **No skate shoes, slip-ons, boots, high tops, coloured laces, ballet type, suede or canvas shoes will be accepted.** Some of these shoes do not provide sufficient protection when students are participating in learning experiences or in the playground.
- During HPE lessons, or while competing on sport days, sport-specific shoes can be changed into if necessary. All black leather lace-up school shoes are required during class time, before school and during lunch breaks at all times.
- Sport Carnival Days: On sport carnival days students are encouraged to support their house by wearing house colours. Attire must take into account sun safety and be appropriate to a school setting. Appropriate footwear is required.

Hair/Hair accessories:

- Hair must be clean, neat and tidy. Styles should be appropriate to school. Hair colour must be natural tones.
- Students with long hair are requested to have it tied back neatly. PLEASE NOTE: Student's hair must be tied back for any practical component of subjects as per Workplace Health and Safety Guidelines. Any ribbons worn must be navy.

Make-up:

- No visible make-up or nail polish is to be worn.
- No acrylic, gel or false nails of any kind.
- No false eye-lashes of any kind.
- Sunscreen that is of a natural tone is encouraged to be worn.
- **If a student does not comply with this policy, the student will be asked to remove the make-up and supervised restorative lunch duty will be issued.**

Jewellery:

- A watch is optional. Items worn on necklaces for religious purposes must be long enough to be concealed below the uniform neckline. Students with pierced ears may wear a maximum of two gold or silver studs or sleepers in each ear lobe. No spacers in the ear(s) are allowed. For safety, during sport only studs may be worn.
- No facial or body jewellery permitted. A clear 'retainer' may be worn to keep the piercing from closing. Piercings CANNOT be covered with a Band-Aid.
- Tattoos, if present, must be concealed and not visible.
- No other visible jewellery is permitted.
- **If a student does not comply with this policy, the student will be asked to remove the jewellery and supervised restorative lunch duty will be issued.**

Winter Uniform – Term 2 and Term 3 Only

- Students may wear a plain (motif free) navy scarf and gloves. No other colours are permitted and under no circumstances can the item of clothing cover the student's face.
- Year 12 students have the option of purchasing and wearing a senior jersey in accordance with school guidelines

Sports Uniform

- Students are allowed to wear sports uniform to and from school on school sports day. Full School Formal Day Uniform is worn to and from school on all other days. Students change for Physical Education classes. Presentation must be consistent with school uniform policy and in accordance with Workplace Health and Safety Legislation.

Undergarments:

- Long sleeved t-shirts are not permitted. White t-shirts may be worn but should not show through the uniform. No t-shirts or long sleeved t-shirts are to be worn outside the uniform. Any undershirts / garments must be tucked in so they are not visible.

Hats:

- At Elanora SHS sun safety is a priority. Any hat worn must be an ESHS hat. All students in Year 7 will be issued with a bucket hat or cap with the school logo. Students in Years 8-12 may purchase a cap or bucket hat with the school logo from the Uniform Shop. These hats are required to be worn for any activity in the sun, including during break times in the 'Hat Zones' (see map).
- It is recommended that all garments are labelled with the student's name.

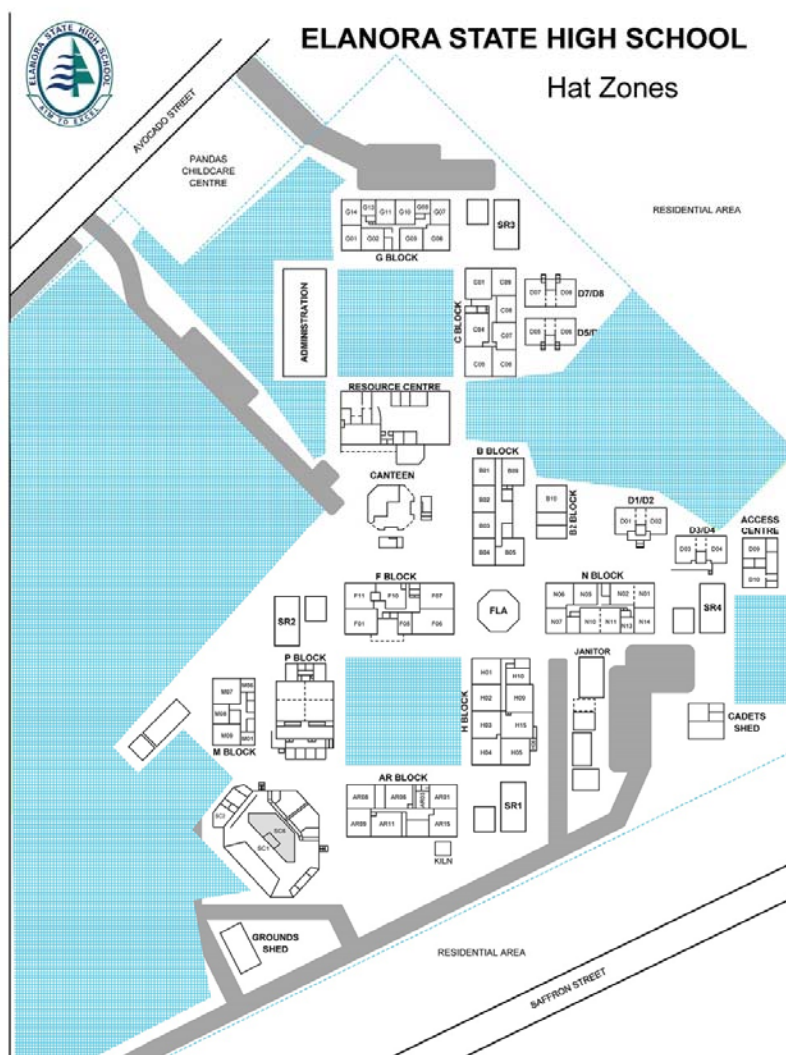



Under no conditions are hoodies or beanies allowed.

Parents, we believe it is the student's responsibility to see their uniform is ready for school. They are old enough to wash and iron them if something prevents you from doing so.

On the rare occasion that a student is unable to be correctly attired, they are required to follow the **Out of Uniform Procedure**. For infringements of the school uniform code the Education (General Provisions) Act 2006 allows schools with dress codes like Elanora State High School to:

- Impose a detention for a student during lunch or after school (if after school, parents are informed before detention occurs);
- Prevent student from attending, or participating in, any activity for which student is representing school; or
- Prevent student from attending or participating in any school activity that is not an essential school educational program.
- Support the student to comply with the dress code using loan items or removal of inappropriate items.

N.B. Students are reminded when they are in our school uniform outside of the school grounds that they are representatives of Elanora SHS and are required to behave and wear the uniform in an exemplary manner. Bringing the school into disrepute is dealt with under the *Responsible Behaviour Plan For Students*.

Junior school students (Years 7-9) wear the Junior School uniform and students in Years 10-12 wear the Senior School uniform.

Out of Uniform Procedure

- Prior to the commencement of the school day, any student out of uniform is required to report to the Wellbeing Hub.
- If the student has a note from a parent/caregiver with a valid reason, or comes to the Wellbeing Hub of their own accord before school begins, the student is provided with a loan item of clothing for the day and no consequence is applied.
- If the student is found in breach of the Uniform Policy and has not visited the Wellbeing Hub, the student is provided with a loan item of clothing for the day and a supervised lunch duty is issued.
- Failure to follow the Out of Uniform Procedure will result in referral to the Head of House for consequences in line with the school's *Code of Conduct*.

Under no circumstances can a person(s) who is not enrolled at Elanora SHS enter the school grounds wearing part of the Elanora SHS uniform. Any student providing an outsider with items of Elanora SHS uniform by which they seek to enter the school grounds will be dealt with as a major violation of the *Elanora SHS Code of Conduct*.

✓ Examples of approved shoes ✓



X Examples of inappropriate shoes X



Example of appropriate socks

